

MARANATHA BAPTIST ACADEMY

Parent and Student Handbook

MBA School Verse

“And be not conformed to this world: but be ye transformed by the renewing of your mind, that ye prove what is that good, and acceptable, and perfect, will of God.”

Romans 12:2

MBA COLORS

Royal Blue/Gold/White

MBA MASCOT

Warriors

MBA THEME

Christ Centered Education

“Reaching Families for Christ”

Parent/Student Handbook

Table of Contents

INTRODUCTION	6	Attendance/Absence	17
Welcome	6	Class Cuts	18
Worthwhile Purpose	6	General Practice	18
Our History	6	Required Events	18
Doctrinal Statement	7	DRESS AND APPEARANCE	19
Purpose Statement	7	General Information	19
Philosophy of Education	7	Performance Dress:7th-12th	20
Mission	7	ACADEMIC INFORMATION	21
Goals	8	School Day	21
POLICIES AND PROCEDURES	9	Preschool	21
Admission Policy	9	Kindergarten	21
Enrollment Procedures	10	Elementary School	21
Re-enrollment	10	High School Schedule	21
Health Concerns	10	Junior High School	22
Financial Information	12	Senior High School	22
Solicitation	12	Credit Requirements	22
Withdrawal	12	Senior Credits	22
Visitors	12	Report Cards and Grades	22
Donations	13	Honor Roll	23
Closing of School	13	Make-up Work	23
Cell Phones	13	Progress Reports	23
Safety Drills	14	Course Change	24
Field Trips	14	Textbooks	24
Parent Chaperones	14	Reference and Text Materials	24
Parent-Teacher Conferences	14	P.E. Uniforms	24
Home Visits	14	Homework	24
Teacher Qualifications	14	Promotion/Retention	25
Lunch Program	14	DISCIPLINE CODE	26
Student Drivers	15	Behavior	26
Student Activities	15	Attitude	26
Eligibility	15	Fundamental Rules	26
Sports Program	15	Foul Language	26
Fine Arts	16	Music	27
Before/Aftercare	16	Prohibited Articles	27
Closed Campus	17	Loitering	27
Tardiness	17		
Appointments	17		

Parent/Student Handbook

Table of Contents

Gum	27
Non-school Functions	27
Couples	27
Office Referrals	27
Probation	27
Suspensions/Expulsions	28
Discipline: Preschool-3rd	29
Discipline: 4th-6th	29
Discipline: Jr. and Sr. High	30
Corporal Discipline	30
Demerit Penalties	31
Social Network	32
Conduct Away from School	32
Closing Word	32

Introduction

*“Nay, in all these things we are more than conquerors through him that loved us.”
Romans 8:37*

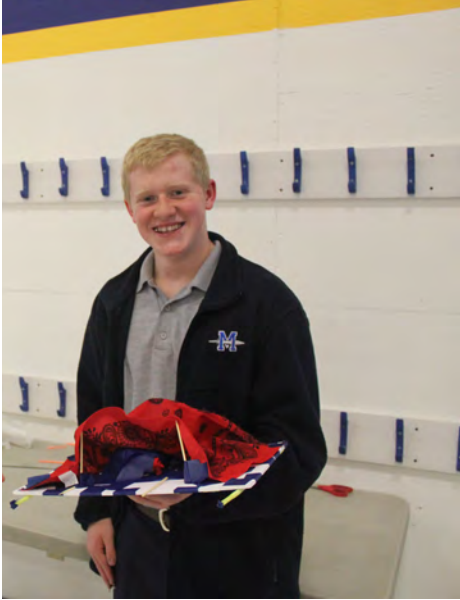

WELCOME

Welcome to the Maranatha Baptist Academy family. We are thankful for the opportunity to work with you concerning the education of your child. We have committed our lives to provide families the best Christian education available in the Fort Leonard Wood area. MBA, a ministry of Maranatha Baptist Church, is a private institution offering a challenging educational program in a conservative Christian environment for members of MBC and, as space permits, other selected families.

To better acquaint you with our mission and focus, please take a few moments to read this handbook. It will help explain the policies and procedures by which we operate.

WORTHWHILE PURPOSE

The purpose of MBA is to bring glory to God by assisting parents in the Biblical training of their children by providing an environment in which students can grow spiritually as they learn to conform to the image of Christ. We believe we can accomplish this goal through the integration of Biblical principles in the classroom, the example of Godly teachers, and the positive peer pressure of other Christian students.

We desire to be an extension of the Christian home. Strong linkage between home, church, and school has proven to be one of the most important factors in a child's success in our school.

Our students are expected to demonstrate self-discipline, high morals, good habits, respect for others, responsibility, and a love for God and country. The Bible, while not being the only textbook, will be taught, and its principles will be guidelines for all learning.

OUR HISTORY

MBA began in 1981 as a ministry of Maranatha Baptist Church. Since its founding, the school has enabled Maranatha Baptist Church to serve our community by providing families with quality Christian training through a balanced academic program. The Lord has greatly blessed the ministry of the school which now includes students from preschool through twelfth grade.

MBA is known throughout the community as an excellent school and is currently the largest private school in

the area. We are an active member of the American Association of Christian Schools and the Missouri Association of Christian Schools.

DOCTRINAL STATEMENT

The Statement of Faith of Maranatha Baptist Church is the doctrinal statement of Maranatha Baptist Academy. A brief summary is as follows:

1. We believe the Bible to be the inspired, the only infallible, authoritative Word of God our final authority for faith and practice.
2. We believe that there is one God, eternally existent in the persons of Father, Son, and Holy Spirit.
3. We believe in the deity of our Lord Jesus Christ, in His virgin birth, in His sinless life, in His miracles, in His vicarious and atoning death through His shed blood on the cross, in His bodily resurrection, in His ascension to the right hand of the Father, and in His personal return in power and glory.
4. We believe that all men are sinners by nature and that salvation is only obtained by the regeneration of the Holy Spirit.
5. We believe in the resurrection of both saved and lost; they that are saved unto the resurrection of life, and they that are lost unto the resurrection of damnation.
6. We believe in the spiritual unity of believers in our Lord Jesus Christ.
7. We believe in the present ministry of the Holy Spirit by whose indwelling the Christian is enabled to live a godly life.

PURPOSE STATEMENT

Maranatha Baptist Academy, a ministry of Maranatha Baptist Church, exists to bring glory to the Lord by reaching students and their families with the Gospel of Jesus Christ and providing an environment where students can grow spiritually as they learn to conform to the image of Jesus Christ. (Matthew 28:18-20, Rom. 12:2)

PHILOSOPHY OF EDUCATION

We believe God gave the Biblical mandate for education to the home and the church. (Genesis 6:7; Eph. 6:4, Matt. 28:19-20) MBA, as a ministry of MBC, desires to be an extension of the home and church in reinforcing the Biblical and academic training provided by these two institutions.

MISSION

MBA seeks to partner with parents to cultivate Christlike young people through the integration of Biblical principles in the classroom, the example of Godly teachers, rigorous academics, and the positive peer pressure of other Christian students.

(Col. 3:16, Ecc. 9:10, I Tim. 4:12)



GOALS

Because MBA's goal is Christlikeness, there are four areas we seek to help parents develop in their young people.

“And be not conformed to this world: but be ye transformed by the renewing of your mind, that ye may prove what is that good, and acceptable, and perfect, will of God.”

– Romans 12:2

SPIRITUALLY

“Let the word of Christ dwell in you richly”

(Colossians 3:16).

- To lead each child to a personal acceptance of Jesus Christ as Savior
- To enrich the child's devotional life
- To awaken a realization that God has a purpose and plan for each life
- To develop the ability to find answers from the Scriptures on his own
- To give knowledge, love, and understanding of the Bible
- To instill a sense of responsibility for the lost that will lead to effective witnessing

MENTALLY

“Let this mind be in you, which was also in Christ Jesus”

(Philippians 2:5).

- To impart a command of common knowledge and skills
- To discover and develop individual aptitudes
- To cultivate analytical thinking and a priority-directed life

SOCIALLY

“None of us liveth to himself”

(Romans 14:7).

- To instill a loyalty to Jesus Christ in all things and at all times
- To develop an understanding of the student's place and obligations within the family
- To help the child share his Christian responsibility as a citizen
- To awaken and foster missionary responsibility toward all men

PHYSICALLY

“Present your bodies a living sacrifice... unto God”

(Romans 12:1).

- To develop a respect for the body as the temple of the Holy Spirit
- To teach intelligent care of the body
- To encourage the yielding of the body as an instrument for God's use



Policies and Procedures

*“Let all things be done decently and in order.”
1 Corinthians 14:40*



ADMISSION POLICY

Students are tentatively accepted at Maranatha Baptist Academy after a successful interview with the parents and administration. A student must be the appropriate age on or before October 1st in order to enter preschool or kindergarten. All students going into the K3 program who are not 3 by October 1st must wait until their third birthday to apply for admission. Final acceptance is contingent upon a review of the permanent records of the student's previous schooling and the results of any necessary testing. The school administration assumes the final responsibility for the grade placement of any student. Transfer students are accepted during any point in the school year. They will be tested in math and English to determine grade placement.

Maranatha Baptist Academy admits students of any race, color, and national or ethnic origin to all the rights, privileges, programs and activities generally accorded or made available to students at the school. Children with special needs such as physical, mental, emotional, behavioral, or learning disabilities that require significant accommodation may be accepted on an individual basis.

Parents are required to sign the Statement of Cooperation. No student will be admitted or allowed to remain in MBA who does not agree to cooperate with the overall purpose and program.

All new students are admitted on a nine-week probationary standing. Once the student demonstrates Christian character, academic competence, and self-discipline, the probationary standing will be dropped.

Students who are expelled or asked to withdraw from MBA become eligible for enrollment consideration after two full semesters following their dismissal from school.

Junior and senior high students must have accepted Jesus Christ as their personal Savior and agree to attend a minimum of two church services a week at a Bible-preaching church that practices water baptism by immersion. They also must agree not to listen to rock music of any kind both at and away from school. These policies apply to both new and returning junior and senior high students.

ENROLLMENT PROCEDURES

A student may register for school in the office during regular office hours. All transfer students are asked to bring a copy of their most recent school records to their interview with the administration. Enrollment is not finalized until the following steps have been completed:

1. Application to MBA completed
2. Registration fee paid
3. Personal interview
4. Student record forms completed
5. Photocopy of student's birth certificate or passport on file
6. Required physical examination and immunizations current and dental and vision screenings if required.
7. Any necessary testing completed

RE-ENROLLMENT

During the month of March, reenrollments for the fall term for current students are accepted on a first-come, first-served basis. Reenrollment forms should be completed and returned with the reenrollment fee to the office. Enrollment is open to the public beginning April 1.

HEALTH CONCERNS

Illness or Injury—

Students who become ill or injured during the school day will be assisted by one of our school office staff. If a determination is made that paramedic assistance is necessary, 911 will be called and the child will be taken to a nearby hospital. Any student with a temperature of 100 degrees or above, or who has experienced vomiting or diarrhea within the previous 24 hours, will not be allowed to remain in school. The parents will be contacted and asked that

the child be taken home or to a doctor.

Medication—

Whenever possible, medication should be administered in the home. At times when medication must be given during the school day, parents are responsible to ensure that all medication, along with written orders from a physician, be turned in to the school office as soon as the child arrives at school. Written permission from the parent or guardian is necessary for a child to receive medication during school hours. Whenever feasible, the child should self-administer medication under adult supervision.

Physical Examinations—

Students entering preschool, kindergarten, fifth, and ninth grades are required by the State of Missouri to have a current physical examination within one year prior to starting that grade level. Transfer students must meet the same requirement. Before participating in the interscholastic sports program, a student must have a physical exam within one year of the start of the specific sport.

Immunizations—

All immunizations must be current according to the requirements of the State of Missouri. Students who fail to comply with these requirements may not be allowed to attend. Transfer students are expected to meet the same requirements.

Records—

All required health records are due by the beginning of school. If they are not submitted by November 1, a student may lose his privilege to attend Maranatha Baptist Academy.

Participation—

As a general rule, if a student is well enough to attend school, he is well enough to attend physical education classes and recess. With written parental verification,

a child may be excused from physical education or outdoor activities for up to three days following an illness or injury.

Insurance—

It is the policy of MBA that any student injured on school grounds will need to submit an insurance claim through the parent’s insurer first. If the claim is rejected, the school does have a limited accident policy so that the office can submit a claim on behalf of a student.

Communicable Diseases—

Maranatha Baptist Academy desires to maintain a healthful school environment by instituting controls designed to prevent the spread of communicable diseases. The term “communicable diseases” shall mean an illness which arises as a result of a specific infectious agent which may be transmitted either directly or indirectly by a susceptible host, infected person, or animal another person.

Any student or employee with a communicable disease for which immunization is required by law or is available, shall be temporarily excluded from the school while ill and during recognized periods of communicability. Students and employees with communicable diseases for which immunization is not available shall be excluded from school while ill. If the nature of the disease and circumstances warrant, Maranatha Baptist Academy may require an independent physician’s examination of the student or employee to verify the diagnosis of communicable disease. Maranatha Baptist Academy reserves the right to make all final decisions necessary to enforce its communicable disease policy and to take all necessary actions to control the spread of communicable diseases within the school.

A teacher or administrative official who reasonably suspects that a student or

employee has a communicable disease shall immediately notify the school principal. The reportable diseases include the following:

- Acquired Immune Deficiency Syndrome (AIDS)
- AIDS Related Complex
- Amebiasis
- Anthrax
- Botulism
- Brucellosis
- Chancroid
- Chicken Pox
- Conjunctivitis
- Dengue
- Diphtheria
- Encephalitis
- Giardiasis
- Gonorrhea
- Granuloma Inguinale
- Hansen’s Disease
- Hepatitis
- Herpes Simplex
- Histoplasmosis
- Human Immunodeficiency Virus
- Legionaire’s Disease
- Leptospirosis
- Malaria
- Meningitis
- Meningococcal Disease
- Mumps
- Pertussis
- Poliomyelitis
- Psittacosis
- Rabies
- Ring Worm

Rocky Mountain Fever
Rubella congenital
Salmonellosis
Schistosomiasis
Shigellosis
Smallpox
Syphilis
Tetanus
Toxoplasmosis
Trichinosis
Tuberculosis
Tularemia
Typhoid Fever
Typhus
Vibrio Cholera
Yellow Fever

FINANCIAL INFORMATION

A tuition and fee schedule has been established for the convenience of our school families. Our tuition rates are reduced for each additional child in a family. The registration and student fees are non-refundable.

Maranatha Baptist Academy receives its income from tuition and fees and does not receive any income from state or federal funds. Parents are asked to pay their tuition and fees when due.

Parents that fall behind in their monthly payments and make no attempt to work with the administration concerning the matter may forfeit the right to enroll their student for the following quarter/semester.

Records will not be processed and report cards will be withheld until all bills are paid in full. Students with delinquent accounts may not be allowed to participate in semester exams, final exams, graduation

exercises, or any extra-curricular activities.

Families who choose to use our monthly payment plan have the option of spreading out the payments over a 10 or 12 month period with each payment due on the 1st of the month unless other accommodations are made through the school office. A late fee of \$35.00 will be added if payment is not received by the 5th of each month. Returned checks are subject to a \$25.00 fee.

If a student attends one day or more of school during any month, he will owe the full month's tuition. Students who are suspended, expelled, or withdrawn from school will receive no refund for the portion of the month they did not attend. No refunds will be given for days off school that were not specified as days off on the school calendar.

SOLICITATION

Soliciting is forbidden at MBA without the permission of the administration. This includes the selling of tickets, candy, etc. and the distribution of political materials or the circulation of petitions. Any promotion of events outside of MBA, religious or not, must be approved through the school office.

WITHDRAWAL

Withdrawals from school must be made in writing through the school office. It is understood that the tuition is due and payable until the official withdrawal form has been completed and delivered to the school office. Textbooks and other school-owned materials are to be returned at the time of withdrawal.

VISITORS

Visitors are welcome at Maranatha Baptist Academy. We do, however, ask that all visitors report to the school office immediately upon arrival. We also ask that

visitors dress in a conservative manner. Some basic dress guidelines are as follows: no shorts, no low-cut blouses or shirts, and no tight-fitting clothing. Students are allowed to visit in classrooms only if they are prospective Maranatha Baptist Academy students. Permission must be obtained from the school administration prior to the visit. Prospective students below third grade are asked to have a parent or guardian present during their classroom visit. Parents are always welcome to visit classes. In order to provide uninterrupted instruction, we ask that such classroom visits and teacher conferences be scheduled in advance through the school office. Teachers are happy to arrange conferences with parents as needed, but please be considerate of the classroom learning environment.

DONATIONS

Maranatha Baptist Academy endeavors to keep tuition rates low for the benefit of our families. Many individuals have helped us maintain our low tuition profile by contributing in one or more of these suggested ways: (1) gifts to special building and remodeling projects; (2) gifts for special equipment purchases; or (3) gifts for the scholarship fund. For further information, contact the business office.



CLOSING OF SCHOOL

On the first snow day for Waynesville schools, we will also CLOSE. If Waynesville has a second consecutive snow day, we will make our own determination if we are able to have school due to the fact that we do not run buses. If our school is open, but you do not feel safe driving, your child will be excused from school.

When the school has been closed, this information is given on the following radio and television stations: KJPW/KFBD (97.9 & 102.3) or KFLW (98.9 FM) to specifically hear that MARANATHA is closed or open (we usually get listed last!). You may also check their website at kflw989.com. The radio stations get our closing/opening information out faster than the TV stations, although we do call KOLR10 & KY3 in Springfield if we plan to close.

An e-mail, voice message, and text will also be sent to parents as soon as a decision has been made to close school.

CELL PHONES

Students bringing cell phones (or other electronic devices) to school must abide by the following guidelines. All cell phones must be dropped off at the school office immediately upon entering the school building. Cell phones must be powered off (not just in silent or vibrate mode) before a student enters the school and must remain off until the student leaves the school building. Students may not turn on or use cell phones during the school day unless they have first obtained permission from the school office. The office will grant permission for a student to use his cell phone only in an “emergency” situation. Once permission has been granted, a student may use his cell phone in the school office or lobby only and must power the phone off and return it before leaving the school office or lobby.

Students may pick up their cell phones only as they leave the building on their way home. Cell phones may not contain anything of a prohibited nature such as ring tones that include rock music, inappropriate photos, etc. Maranatha Baptist Academy will not be responsible for lost, stolen, or damaged cell phones.

SAFETY DRILLS

Safety drills are scheduled periodically at different times during the school year. It is important that students move quickly and in an orderly manner to the assigned area as soon as the alarm is sounded. Specific directions are posted in all classrooms. In case of severe weather or other emergency, students will remain in the building in safe areas. In full cooperation with the local and state safety officials, precautions will be taken for the safety and protection of the students.

FIELD TRIPS

Field trips are taken at various times during the school year to places of educational interest. Students are required to maintain the same level of discipline away from the school as is expected at the school.

PARENT CHAPERONES

There are times throughout the school year when parents may serve as chaperones or assist in the classroom. In such cases, parents are asked to follow the same code of dress and conduct as is required of the students. Parents serving as chaperones are asked to assist the teacher in maintaining the school's expected standards of safety and behavior. Generally, the parent chaperone should not bring non-school-age children to the activity.

PARENT/TEACHER CONFERENCES

The school is intended to be an extension of the home. Maranatha Baptist Academy recognizes the importance of the home and the school working together to obtain spiritual and academic growth for the student. Therefore, dates are scheduled following the end of first and second quarters every year for parents to come to the school and meet with teachers to discuss the needs of the student.

Parent-teacher conferences may be necessary throughout the school year in order for parents to know first-hand their child's progress. The school asks that all students and parents participate as needed in these beneficial conferences.

HOME VISITS

Each preschool through sixth grade teacher is asked to visit the homes of new students early in the school year. The purpose of the visit is to become acquainted with each child's family and to discuss his/her individual needs at school. Teachers will arrange their home visits in advance.

TEACHER QUALIFICATIONS

Every teacher in MBA must be qualified spiritually and professionally. All teachers and staff employees are born again Christians who have dedicated themselves to Christian education. They are all active members of Maranatha Baptist Church. Teachers are required to have adequate preparation in their subject areas and are supported in their pursuit of graduate studies.

LUNCH PROGRAM

MBA offers a lunch program throughout the school year which provides a meal and milk or juice. Students can either purchase this school-provided lunch or they may bring their lunch from home.

STUDENT DRIVERS

Any student who possesses a valid driver's license may drive to school. However, permission must be obtained from the administration before the student may drive on a regular basis.

Any student who demonstrates careless or reckless driving habits will forfeit the privilege of driving on campus. As soon as students arrive at school in a car driven by a student driver, they must leave the car and go into the building. Even if a student drives only himself to school, he must park, exit, and lock the car immediately upon arrival.

Students may not return to their car until they are dismissed at the end of the day. While carpooling with parents is encouraged, under no circumstances are students to transport anyone other than those assigned by parents to ride with that student driver. And, under no circumstances will mixed couples be allowed to leave the school grounds or a school function/sporting event without an adult present with them serving as a chaperone. All automobiles are to be locked while parked on the school grounds.



STUDENT ACTIVITIES

Students who participate in bands, choirs, athletic teams, plays, or any special program groups at MBA are required to attend all functions in which these groups participate. Students and parents should plan their individual schedules to minimize conflicts.

ELIGIBILITY

Only eligible students who meet certain requirements qualify to participate in the sports program, or any other extra-curricular functions which have eligibility requirements as the basis for participation. Eligibility requirements are as follows:

1. Participants may not have 25 or more demerits in any one semester.
2. Participants must have at least a "C-" average for the marking period.
3. Participants must have no "F's" for the marking period.
4. Family's account must be current.

Academic eligibility is determined by progress reports and grading periods. Any students declared academically ineligible may not participate in school field days or any other extra-curricular functions for at least three weeks.

Students who are absent from school (except for approved class cuts) will not be allowed to attend or participate in after-school activities of any kind on the day of their absence. Students must arrive at school by 9:00 a.m. and stay for the remainder of the school day in order to be eligible to participate.

SPORTS PROGRAM

Maranatha Baptist Academy maintains an active inter-scholastic sports program competing in basketball, volleyball, and soccer. Athletes must meet eligibility

requirements.

Student athletes are expected to maintain a good Christian testimony with staff and students. Any student failing to maintain the required grade point average will not be allowed to participate in games for a minimum of three weeks or until the next satisfactory progress report.

All students participating in MBA athletics are required to have a satisfactory physical examination before beginning practice. Athletes are encouraged to take the examination after June 1 so that they will be covered for the entire athletic season.

In all sports, the coaches recommend athletes for awards based on participation, training, sportsmanship, cooperation, behavior, and attitude. Athletes are expected to attend all practices and games.

Coaches may drop athletes from squads for irregular attendance at practice. They may also be dropped for lack of ability to perform at the standard set for squad membership or for displaying an improper attitude.

FINE ARTS

The purpose of our music program is to develop within our students an appreciation for music that honors the Lord. For the Junior and Senior High, choir must be taken for credit at Maranatha Baptist Academy. Band is also a mandatory class for all students from 5th-9th grade. Students that are gifted in the field of music may wish to sign up for private music lessons in voice, piano, and other instruments. Lessons are available on a case by case basis at the school for a fee to be set by the music instructor.

Private lesson registration forms and rates are available through the music director's office. Lessons will be

scheduled before and after school hours. Students taking music lessons will have opportunities to perform at various school programs, contests, concerts, and in chapel. Participants in fine arts performances are expected to meet eligibility requirements.

Students may also be given the opportunity to perform in the Missouri Association of Christian Schools' Bible, Academic, and Fine Arts Competition held in Kansas City, Missouri. All students taking choir and band for credit must attend the Fine Arts Competition when our school participates. We ask that parents make sure to keep these dates open for their student.

CHILD CARE AND EARLY ARRIVAL/ LATE STAY

Maranatha Baptist Academy provides child care service for our students in preschool through 12th grade. Child care hours are from 7:00 a.m. to 5:30 p.m. Teachers will be on duty at 7:35 a.m. each school day.

K3-4th

Students from K3-4th grade arriving before 7:40 will need to sign up for the early care program.

Parents needing child care during the 3:00-4:00 time period will need to enroll their student in the afternoon care program provided by the academy.

Parents needing child care later than 4:00 will need to sign up for the late stay program. Early/Late care information sheets are available through the school office.

The early morning child care rooms open at 7:00 a.m., and students should not arrive prior to that time. Students who remain at school after the regular dismissal time must be involved in an official extra-curricular activity or be enrolled in the after school child care program. No student is

to be in the school building without adult supervision.

Parents that have students who are not enrolled in child care programs and arrive at school after 7:40 and picked up before 3:00 will not be charged for child care.

5th-12th

Students arriving at school after 7:35 will go immediately to their homerooms. Students arriving before 7:35 a.m. must report to the early arrival room. Students arriving early or staying past 3:00 p.m. must sign up with the school office for the early/afternoon care programs and make the appropriate financial arrangements in the school office.

Parents that have students who are not enrolled in child care programs and arrive at school after 7:40 and picked up before 3:00 will not be charged for child care.



CLOSED CAMPUS

Maranatha Baptist Academy operates on the “closed campus” principle. This simply means that attendance at school is required from the regular start of classes to the regular dismissal time, regardless of the number of free periods a student may have. Students may not leave campus for lunch.

TARDINESS

Students will be expected to be on time to school and all scheduled activities during the school day. Students who come to school late or who are delayed in going to first hour class, should go directly to the office to sign in. Please help your child learn responsibility by insisting that he arrive on time for school. Three tardy days constitutes one absence. Habitual tardiness may result in suspension from school.

APPOINTMENTS

Parents arriving during class time to pick up students for dental and doctor’s appointments, or other excused absences, should report to the office. If a student must leave school early, a written note from the parent is to be brought to the school office.

ATTENDANCE/ABSENCE

In order to gain the most from school, each student must be regular in attendance. Absences will be excused for the following reasons:

1. Illness
2. Death in the immediate family
3. Medical appointments
4. Excused class cuts

Parents should notify the school office in advance of the absence whenever possible. In the case of illness, parents are asked to call the school office before 9:00 a.m. stating the specific reason for the absence.

Unless notified, the school will attempt to call the home of the absentee. After an absence, the returning student should bring a note explaining the reason for the absence. No refunds on tuition are made because of absences.

Unexcused absences will result in a two point deduction from each class at the end of the quarter, and unexcused absentees will not be able to make up any work missed.

Any student absent for twenty or more days during the school year may be retained at the same grade level. In junior and senior high school, this would result in a loss of credit for any course in which the student has accumulated thirty absences.

CLASS CUTS

A maximum of five days of class cuts are permitted each semester for unavoidable absences. These are for non-school-sponsored parent-attended activities including church-sponsored functions, college visits, and family vacations. If possible, family vacations should be restricted to days when school is not in session. Individual student vacations or other activities that do not include parents will not be approved.

Class cuts are to be arranged at least two school days prior to the absence. Parents of elementary students are asked to arrange class cuts through their child's teacher. Junior and senior high students arrange class cuts through the school office by completing a "Excused Absence" form.

Class cuts may not be taken during the first two weeks of the school year or during the final two weeks of each semester. Transfer students may not take class cuts within two weeks of their admission date.

GENERAL PRACTICE

No visitor may speak or perform in any program or class unless permission is secured in advance from the administration.

No student may use the name of the school on any radio or television program or in any publication without prior authorization from the school administration.

REQUIRED EVENTS

The following days are required as mandatory attendance days for all Jr. and Sr. High students:

Leadership Conference

Christmas Concert

Spring Concert

Fine Arts Competition

Awards Ceremony

High School Graduation

Any student who fails to appear at these events without preapproved administrative approval will be subject to academic penalties, and/or disciplinary action in the form of demerits, suspension, or expulsion.



Dress and Appearance

*“...for man looketh on the outward appearance, but the LORD looketh on the heart.”
I Samuel 16:7*



GENERAL INFORMATION

It is the position of Maranatha Baptist Academy that Christian young people should act and dress differently from the world (Romans 12:2).

In order for students to mature spiritually, the teaching of Biblical separation is a vital part of our school's program. I Corinthians 10:31 commands Christians to do all to the glory of the Lord. In today's society, this command has special reference to the fact that God may be honored or dishonored by our personal dress and grooming.

In dress, as well as doctrine, the Christian is to “prove all things, hold fast that which is good, and abstain from all appearance of evil” according to I Thessalonians 5:21-22. I Timothy 4:12 exhorts, “Let no man despise thy youth; but be thou an example

of the believers, in word, in conversation, in charity, in spirit, in faith, in purity.”

Maranatha Baptist Academy believes that these commands have a practical application to the dress and appearance of students.

The underlying principles of MBA's dress code are modesty (I Timothy 2:9, II Timothy 2:22), appropriateness (Philippians 4:5), identification (Colossians 3:16-17; I John 2:15-16), and distinction of sexes (Deuteronomy 22:5; I Corinthians 11:14-15). In light of these principles, we must set an institutional standard for our school and our students that must be met in order for us to be consistent in our enforcement.

Clothing or accessories identified with worldly fads, fashions, activities, or anti-Christian characters are prohibited.

The administration reserves the right to determine what is acceptable or unacceptable in matters of appearance. Students are to dress according to the prescribed uniform guidelines and are to adhere to the appropriate dress code during all school functions, on or off campus, including athletic events, unless otherwise instructed. Students will be counseled privately about any violations, assessed demerits, and may be required to call home for parents to bring a change of clothing or be sent home to change into acceptable attire.

Parents have the prime responsibility in teaching their student to live by standards of Scripture and are responsible to send their children to school in the correct uniform

dress and properly groomed. Students are to arrive according to dress code and remain in dress code while on campus, unless participating in a school-related activity.

Students may not have on their clothing, lunch boxes, backpacks, folders, notebooks, vehicles, etc. anything dealing with secular music stars, movie/TV stars, or cartoon characters. There is to be no discussion of questionable movies, TV programs, or music.

Please refer to the complete student dress code standards on file in the MBA office or download a copy from the school web site



PERFORMANCE DRESS:

7th-12th

During the year, various special performances will be scheduled such as band concerts, choir concerts, and fine arts performances. The dress code for these events is as follows:

Performance Dress - Boys

Pants: Black dress pants

Shirts: White long-sleeved dress shirt; tie purchased through the Academy.

Shoes and Socks: Dress shoes and dark socks

Performance Dress - Girls

Dress: Designated dress purchased through the Academy.

Shoes and Socks: Black dress shoes and nylons.



Academic Information

*“And Jesus increased in wisdom and stature, and in favour with God and man.”
Luke 2:52*



SCHOOL DAY

K3-K5 (Half-Day)

8:00am -12:00pm

K3-6th Grade

8:00am - 2:50pm

7th-12th Grade

7:45am - 2:50pm

Child Care

6:30am - 5:30pm

Office Open

7:00am - 4:00pm

PRESCHOOL (K3—K4)

The preschool is an excellent early childhood learning program teaching children through creative projects in academics, music, art, and poetry. Our preschool classes are designed to provide

a happy learning atmosphere where the teacher can lovingly meet each child’s personal needs. Both preschool classes offer a half day program.

KINDERGARTEN

Kindergarten is an integral part of the total school program. It is not a baby sitting service or play-school, but an enjoyable opportunity to learn phonics-based reading, numbers, printing, music, and art. Students completing the program participate in a beautiful cap and gown graduation ceremony. The kindergarten class offers a half day program.

ELEMENTARY SCHOOL

The elementary program is designed to help students excel in all subject areas. The reading program focuses on mastering phonics. Mathematics, grammar, spelling, science, history, geography, and penmanship are important elements of the curriculum.

HIGH SCHOOL SCHEDULE

Homeroom 7:30am - 7:45am

God and I Time 7:45am - 8:00am

First Hour 8:00am - 8:45am

Second Hour 8:50am - 9:35am

Third Hour 9:40am - 10:20am

Flex Hour 10:25am- 10:55am

Fourth Hour 11:00am-11:45am

Lunch 11:50am-12:20pm

Fifth Hour 12:25pm-1:10pm

Sixth Hour 1:15pm -2:00pm

Seventh Hour 2:05pm -2:50pm

JUNIOR HIGH SCHOOL

The course of study for students entering junior high school provides challenge and motivation to help provide stability in a time of physical and emotional transition. Dedicated Christian teachers and active participation in Christian activities provide students leadership, stability, encouragement, inspiration, and direction.

SENIOR HIGH SCHOOL

Maranatha Baptist High School offers a college preparatory education in a conservative Christian atmosphere. Graduates of our high school have attended colleges and universities all over the United States. Our teachers are known for their willingness to help students learn and for their genuine concern for students' individual needs. Students are given the opportunity to participate in a variety of music, sports, and social activities.

CREDIT REQUIREMENTS

Maranatha Baptist High School requires the successful completion of an academic program accumulating 24 units of credit (4-English; 3-Social Studies; 3-Math; 3-Science; 4-Bible; 2-Music; 1-Physical Education; 1-Foreign language; 1/2-Health; 1/2-Personal Finance; 2-Electives). A passing grade in Bible class is required every semester.

All students in grades seven through twelve must follow the course of study recommended to them by the administration. Listed here are the suggested courses of study for each high school grade level; however, the final class schedule for each year of study may be change based on the number of students in each class. The curriculum used is a mix between Abeka and Bob Jones. The Saxon curriculum is used for math classes.

Ninth

Bible 9
English 9
Algebra I
World History
Physical Science
Foreign Language
Choir/Band
P.E.

Tenth

Bible 10
English 10
Algebra II or
Geometry
U.S. History
Biology
Choir
P.E.

Eleventh

Bible 11
English 11
Algebra II or
Geometry
Geography
Anatomy/Health
Choir
P.E.

Twelfth

Bible 12
English 12
Government
Choir
Personal Finance
Elective 1
Elective 2
P.E.

In addition to these classes, other electives are offered on a rotational basis including the following:

Band, Business Math, Chemistry, Typing, Physics, Advanced Math.

SENIOR CREDITS

Seniors who lack more than one credit will not be permitted to march in commencement exercises. Arrangements must also have been made to earn this credit in an approved program before the student may march. Maranatha Baptist Academy cannot be responsible for the inconvenience caused by a senior's failing courses during the last days of school.

REPORT CARDS AND GRADES

Our reporting system is designed to give parents and students an indication of the progress (or lack of progress) which is being made. Each student's ability, attitude, and application should be taken into account when reviewing your student's grades.

Students are evaluated in their academic subjects and on their conduct. Academic grades are based on the quality and accuracy of work done on homework, quizzes, tests, exams, projects, etc.

Grading is on the following scale:

90 - 100.....	A – Outstanding
80 - 89.....	B – Above Average
70 - 79.....	C – Average
60 - 69.....	D – Below Average
0 - 59.....	F – Failure

In addition to the academic letter grade, each student will also be assigned a conduct grade for each quarter. The conduct grade, an important part of the report card, represents the student’s conduct and the degree of cooperation and effort displayed.

“**A**” indicates that a student is doing work consistent with his ability level, completes work on time, and is no particular discipline problem in the classroom.

“**B**” indicates that a student is working somewhat below his ability level, has some inconsistency in completing assignments, or is developing disciplinary problems in the classroom.

“**C**” indicates that a student is doing less than is expected of him, is often inconsistent in completing assignments, or is a discipline problem in the classroom.

“**D**” indicates that a student is doing far below his ability level, does not complete assignments on time, or is a regular discipline problem in the classroom. Any student who receives a “**D**” will be placed on probation.

“**F**” indicates that a student is making little or no effort in the classroom, has a pattern of not completing assignments, or is consistently a discipline problem and/or a disruption in the classroom. Any student who receives a “**F**” will come under a

review process for potential dismissal from school.

Students may consult their teachers about their course progress at any time.

HONOR ROLL

An honor roll is compiled each nine-week grading period and is made up of the following:

“**A**” Honor Roll - Students who have made all “**A**’s” or “**A**-’s” with no unsatisfactory conduct grades.

“**B**” Honor Roll - Students who have made a “**B**” average with no unsatisfactory conduct grades.

Incomplete grades on a report card not made up by the time the Honor Roll list is due automatically disqualify that student from the Honor Roll for the grading period.

MAKE-UP WORK

Students who are absent must check with classroom teachers immediately upon returning to school to get all missed assignments. Students should use the lesson plans posted online to find out what assignments were expected to be done during the days absent. Students are allowed up to three days to make up work in the case of an excused absence. Work not made up will go on record as a “zero.”

Students are expected to be in school unless ill. No test or examination will be given early so that a student may leave school before the normal dismissal time.

PROGRESS REPORTS

Student progress reports will go out four times a year at four and half week intervals. Progress reports are to be signed by the parents and returned to the teacher within two days.

COURSE CHANGE

Any courses that are dropped or added must be approved by the administration and processed during the first two weeks of the school year. Unless unusual circumstances prevail, a student will retain the same courses throughout the entire year.

No schedule changes may be made at the semester break. Any course with fewer than two students registered may not be offered due to financial considerations.

TEXTBOOKS

High School math textbooks are furnished by MBA and rented to students for a small fee. Learning to accept responsibility in regard to proper care of books and equipment is an important aspect of character development. In case of the loss of textbooks or workbooks, students will be billed for the total price of replacement books. Damaged books will be assessed accordingly.

REFERENCE AND TEXT MATERIALS

Each student will provide himself with a King James Version of the Bible. It is suggested that each student have a good dictionary.



PHYSICAL EDUCATION UNIFORMS

Each junior and senior high physical education student is required to wear a gym uniform. These required uniforms will be on sale on orientation day. Any student who does not have the required uniform will be given one on the first day of practice and parents will be billed for the cost of the uniform.

HOMEWORK

Homework is a necessary part of each child's education. All students will be assigned homework by their teachers. Parents should oversee these assignments nightly.

The purposes for homework are as follows:

For Drill—most students require solid drilling to master material essential to their educational progress.

For Practice—following classroom explanation, illustration and drill on new material, homework is given so that the material will be mastered.

For Remedial Activity—as instruction progresses, various weak points in a student's grasp of subject matter become evident. Homework is given to overcome such difficulties.

Students are expected to accept the responsibility for completing their homework as follows:

- Have the necessary materials to complete their homework.
- Ask questions as needed to clarify their assignments.
- Work as independently as possible.
- Complete their assignments with minimal help from parents.

- Complete their homework in a thorough and thoughtful manner.
- Complete their homework by the due date.

We request that parents assume the responsibility of ensuring that assignments are completed on time. However, this does not mean that parents do the work for the child. The maximum amount of learning, along with the development of personal responsibility, is attained when children are encouraged to recognize that completion of homework is primarily their own responsibility. Repeated delinquent or unfinished homework will result in disciplinary action.

Homework Policy: 1st–2nd Grade

There will be one grace day/warning per quarter for any homework not done. After that a check-mark will be given for each subsequent day the homework is not completed.



Homework Policy: 3rd–12th Grade

Students failing to complete their homework assignments will receive an academic penalty. Teachers will give two days of grace to each student in each subject during the school year. Once the two days are used, the student will receive the grade for the homework as the homework is that day. (Example: Work not turned in would receive a zero. Work partially completed would be graded as is.) Your child’s teacher will communicate with you regarding any issues your child is having in this area.

PROMOTION/RETENTION

In kindergarten through sixth grade, a student’s report card will contain a notation as to whether the student has been promoted or retained. Elementary students receiving three “D’s” for the second semester in academic subjects will be promoted on a probationary trial period only if they complete school-approved summer studies. Students who received “D’s” in three or more academic subjects are required to successfully complete Language Arts in summer school before being promoted. If one of the “D’s” is in math, the student must also successfully complete math in summer school before being promoted.

Students receiving an “F” in three academic subjects, including math and either reading or English, are automatically retained.

Seventh through twelfth grade students who fail either semester of math or English or who earned “D’s” both semesters are required to attend summer school. Students who fail both semesters of any two academic subjects will automatically be retained.

Discipline Code

*“Even a child is known by his doings, whether his work be pure, and whether it be right.”
Proverbs 20:11*



BEHAVIOR

Maranatha Baptist Academy expects students to establish and maintain a Christian testimony with teachers and students. Students are asked to follow school rules to the best of their ability while displaying respect for God, country, family, faculty, and fellow students.

Students are expected to be responsible for their own actions in spite of the actions of others. Disorderly conduct such as horseplay, disruptive talking, bullying, and/or intimidation of others is not conducive to Christian character development. Such behavior lends itself to classroom disturbances which disrupt the learning process. Therefore, this type of behavior will not be tolerated.

ATTITUDE

All students are to do their best to maintain a Christ-like spirit of cooperation at all times. Constructive suggestions are always welcomed, but complaining, griping, or sullenness will not be tolerated.

Making light of Bible classes, Chapel programs, or guest speakers is always unacceptable. No student will be permitted to ridicule or mock school rules or personnel. If improper attitudes persist after parents have been contacted, probation, suspension, or expulsion may result. Suspensions lower a student's nine-week grade by three points in every subject for each day of suspension.

FUNDAMENTAL RULES

At Maranatha Baptist Academy, these four fundamental rules must be followed:

1. Students will ask for permission to leave their seat.
2. Students will ask for permission to speak out in class.
3. Students will always address and reply to teachers with utmost respect.
4. Students will always follow instructions carefully.

FOUL LANGUAGE

The use of foul or vulgar language, either in jest, anger, or absent-mindedness, will be dealt with firmly, even on the first offense. Repeated use will result in immediate suspension or expulsion. Suggestive remarks or actions will be dealt with similarly.

MUSIC

Today's rock music promotes humanistic philosophies, rebellion to authority, alcohol use, drug use, immoral behavior, violence, and foul language. This type of behavior is directly opposed to what we are attempting to incorporate into the lives of our students. With this in mind, we ask that 7th–12th grade students refrain from listening to such music at and away from school. We also ask that students not attend dances or participate in social dancing. Parents are asked to ensure the enforcement of these policies.

PROHIBITED ARTICLES

In an attempt to provide a safe environment for students, staff, and visitors, the possession of weapons of any kind by students, including guns, knives, explosives, and any other objects intended to look like or be used as weapons, is strictly prohibited at school or at activities sponsored by the school. Other prohibited articles include: tobacco products, alcoholic beverages, illegal drugs, dice, playing cards, electronic games, radios, music/video players, and any rock music related items.

Magazines and books not related to class work are not permitted at school. Any literature that is brought to school must be approved for content by the student's English teacher.

LOITERING

Loitering in corridors, restrooms, and parking lots is prohibited. A student is expected to be in assigned areas during the student's scheduled school day.

GUM

Because of the problems gum chewing can cause, students are not to chew gum at any time they are on the school grounds. This restriction includes lunch hour,

physical education class, and before and after school.

NON-SCHOOL FUNCTIONS

The school is not responsible for any party or social function that is not officially approved or sponsored by the school. For all school-sponsored functions, school rules and regulations, including dress standards, apply both for students and their guests.

COUPLES

The following are some regulations that may be of interest to both students and parents:

No couples or mixed groups may be on any part of the school grounds, inside or outside of buildings, unless they are under the general supervision of a school staff member.

There is to be no physical contact between any male and female student before, during, or after school, or at any school or church function. Each student is to be above reproach in his behavior at all times.

OFFICE REFERRALS

Minimum penalties for junior and senior high students who are sent to the office for disciplinary reasons in the same school year are as follows:

1st Referral – 5 demerits

2nd Referral – 10 demerits

3rd Referral – One-day suspension

4th Referral – Two-day suspension

5th Referral – Three-day suspension

6th Referral – Expulsion

PROBATION

Students may be placed on probation for academic, social, disciplinary, or spiritual reasons. Parents will be notified of this action by the school administration. Failure

to consistently improve in the area of concern will result in dismissal from school. Types and definitions of probation are listed below:

DISCIPLINARY—A student is placed on disciplinary probation when he repeatedly or flagrantly ignores, disobeys, or flaunts school regulations and/or teacher instructions. If a student fails to respond to this action, suspension or expulsion may follow.

SPIRITUAL—A student is placed on spiritual probation when he demonstrates little spiritual growth or a general apathy toward spiritual concerns.

ACADEMIC—A student is placed on academic probation when he is failing in all or almost all of his academic classes or when he is showing little effort in assigned class work or tests.

SOCIAL—A student is placed on social probation when he exhibits an inability to comply with the overall social values of the school and/or his interaction contributes to an unreasonable negative behavior in himself or others. This disciplinary action may limit a student's social contact with one or more other students.



SUSPENSIONS/EXPULSIONS

Attendance at MBA is a privilege, not a right. It is never our desire to suspend or expel a student from school. But, unfortunately, situations arise that leave us no alternative.

Students that are given an out-of school suspension for disciplinary reasons will not be allowed to make up missed test or quizzes. Although no make-up work will be accepted for a grade, students will be responsible to get their daily assignments and complete all homework for the suspension period. Out-of school suspensions lower a student's nine-week grade by three points in every subject for each day of suspension.

Students that are given in-school suspensions for disciplinary reasons will not be allowed to make up missed test or quizzes. Although no make-up work will be accepted for a grade, students will be responsible to get their daily assignments and complete all homework for the suspension period. In-school suspensions do not lower a student's overall nine-week grade by three points, but students will receive zeros on all missed homework, quizzes, and tests.

No student will be retained in MBA who becomes involved with alcoholic beverages, illegal drugs, tobacco use, lewd or immoral behavior, or pornographic or lewd material. This applies to the students' conduct at and away from school.

A student will be dismissed from school at any time his lifestyle is found to be out of harmony with the overall spirit, goals, policies, and direction of MBA, or if he has displayed a consistent disregard for the rules and regulations of the school. Decisions in these matters are the responsibility of the administration.

Students who have been expelled or

asked by the administration to withdraw from MBA may not attend school or any school function until the completion of two full semesters following the expulsion or withdrawal. During this period, he/she is restricted from attending any MBA function (including athletic practices or games, fine arts rehearsals, or performances, all programs, graduations, etc.) These restrictions apply to activities both on and off campus. Of course, the child is always welcome to attend the services and activities of Maranatha Baptist Church.

DISCIPLINE: PRESCHOOL THROUGH THIRD GRADE

Expecting perfect behavior from children at all times is simply an unrealistic expectation. In order to help children learn to take responsibility for their own actions and reactions, there are various methods of discipline that can be used to reinforce good behavior: a stern look, warning or reminder, change of seating, or contacting the parents. The following is a list of disciplinary measures that may be taken:

- A. Walking:** For minor rule infractions, students may be asked to walk for part of their recess time.
- B. Check Mark:** If other means of discipline have not been effective, a student's name may be placed on the board followed by a check mark. Checkmark offenses include:

- 1. Disorderly Conduct:**
General goofing around when he/she should be listening and obeying
- 2. Out of Order:**
Running in the halls, hitting, putting hands/feet on others, pushing, etc.

- 3. Work Not In:**
Not finishing homework, not bringing back test folder
- 4. Intentional Disobedience:**
Lying, stealing, cheating, disobedience, etc.
- 5. Attitude:**
Bad attitude, uncooperative, talking back, etc.
- 6. Courtesy:**
Disrespectful, inconsiderate, rudeness, etc.
- 7. Talking:**
Talking without permission at any time.

C. Contacting the Parents: If other means of discipline have not been effective, teachers will contact the parent of student by phone call or through email and let them know about the concerns. It is the parents' responsibility to use the appropriate disciplinary measures to correct the issues.

D. Trip to the Principals office: If the concerns are still ongoing, the student will be sent to the principals office which may result in the administration of corporal discipline.

DISCIPLINE – FOURTH THROUGH SIXTH GRADE

If a student has not responded to a teacher's verbal correction, a Conduct Report may be given. Conduct report offenses in general are for failure to follow instructions and improper attitude or behavior.

Conduct reports are the upper-elementary teachers' way of communicating with a parent a problem the child has in school.

When the student is given a conduct report, his name is written on the board and then will usually walk for a part of the recess. The conduct report is sent home with the student for the parent's review and signature. It is our desire that the parents assist the school in providing the necessary discipline to correct the behavior. When parents provide the necessary discipline, the teacher is allowed to maintain a more cheerful atmosphere in the classroom thus creating a more enjoyable learning environment.

Should it become necessary to maintain control in the classroom, teachers may use other means of discipline including removal of recess, write-offs, or corporal discipline.

DISCIPLINE: JUNIOR AND SENIOR HIGH

The demerit system is a discipline guide for junior and senior high students at Maranatha Baptist Academy. The positive side of discipline is stressed in Proverbs 22:6. The administration expects students at MBA to maintain the highest standards of behavior at all times.

Failure to comply with the standard of conduct will result in the issuing of demerits. Demerits for a student are recommended by the teacher or other staff personnel. The

administration makes the final decision regarding demerits. Students must sign or initial each demerit slip to acknowledge that they have received it.

Students receive demerits according to a written guide that is posted. Students who accumulate fifty (50) demerits in a semester may lose the privilege of attending MBA for a minimum of two full semesters.

A student who accumulates a total of fifty (50) demerits or more in successive semesters may not re-enroll without approval of the administration.

Any student accumulating thirty (30) demerits in one semester will be required to attend a mandatory meeting along with their parents and a member of the administration before being allowed to return to classes.

Any student accumulating twenty-five (25) demerits in one semester will be placed on probation. This means the student cannot participate in any extra-curricular activities including athletics, etc.

Students who receive 1–5 demerits in a semester will have no record of this on their permanent file. Students who receive more than five demerits in a semester will have these recorded but will start the next semester with no demerits.

CORPORAL DISCIPLINE

Maranatha Baptist Academy believes that the goal of all discipline should be to teach students self-discipline. We believe this goal can be successfully accomplished through consistent and effective discipline given through the home and the structured classroom environment created by the teacher. However, we do recognize that at times the school will need to further reinforce the discipline given in the home and classroom in order to correct an ongoing discipline problem at school. In



situations such as this, corporal discipline in the form of swats will be administered.

It is the philosophy of the MBA that corporal discipline, administered appropriately and correctly, is not only effective in solving behavior issues, but it is also in accordance with Biblical teachings on discipline (Proverbs 13:24; 22:15; 29:15). All parents will be required to give their consent allowing for the use of

corporal discipline. Swats will be issued at the discretion of the administration. Offenses that may result in corporal discipline include, but are not limited to, the following: ongoing behavior problems, lying, fighting, and disrespect to authority.

A parent's refusal to partner with the school on this matter will necessitate a student's immediate withdrawal from school.

DEMERIT PENALTIES

Our 7th-12th grade demerit system addresses, but is not limited to, the following:

OFFENSE	1	2	3	4	5	6	7	
1. Tardiness	1	1	1	2	2	2	3	Thereafter
2. Littering	1	1	1	2	2	2	3	Thereafter
3. Disorderly conduct	1	1	1	3	3	3	5	Thereafter
4. Failing to follow instructions	1	1	1	3	3	3	5	Thereafter
5. Candy, food, gum, etc.	1	1	1	3	3	3	5	Thereafter
6. Hall violation	1	1	1	3	3	3	5	Thereafter
7. Dress code	1	1	3	5	5	5	5	Thereafter
8. Cellphone/electronics	1	1	3	5	5	5	5	Thereafter
9. Disrespect	3	3	5	5	10	Thereafter		
10. Disobedience	5	5	5	10	Thereafter			
11. Unexcused absence	5	5	5	10	Thereafter			
12. Prohibited article	5	5	10	10	Thereafter			
13. Horseplay	5	5	10	10	Thereafter			
14. Vulgarity or profanity	5	10	15	20				
15. Inappropriate internet post ²	5	10	15	20				
16. Defacing property	5	10	15	20				
17. Music infraction ^{1,2}	5	15	25					
18. Cheating or lying	15	25						
19. Skipping class	25	25						
20. Tobacco infraction ¹	50							
21. Drugs/alcohol ¹	50							
22. Pornography/lewd material ¹	50							
23. Stealing ¹	50							

¹ At/away from school

² Entire school year (more than three offences is cause for dismissal)

SOCIAL NETWORKING

We believe the internet can be a very useful tool for academics and communication, but we also realize that the unsupervised use of the internet, especially relating to social networking sites such as *Facebook* and *Twitter*, can result in damaging the testimony of MBA and our students. Therefore, the administration reserves the right to discipline students that post information and pictures that are contrary to the policies of MBA regarding moral standards and student conduct. Because of the potential of severe damage to the testimony of students and the school, the administration will need to enforce these policies whether the student is in school or out of school. Failure to comply with the school regarding this policy will necessitate a student's immediate withdrawal from Maranatha Baptist Academy.

CONDUCT AWAY FROM SCHOOL

Maranatha Baptist Academy students are reminded that they represent the Lord and the school when they are away from MBA as well as when they are on campus. Student are to present a good testimony to everyone who sees them. MBA students represent the school every day of the year and are disciplined for indulging in smoking, drinking, drugs, sexual misconduct, pornography, dancing, and attending unacceptable music concerts. Both students and parents are expected to maintain a Christian testimony during athletic events.

A CLOSING WORD

God has ordained two institutions to educate the child: the home and the church. The education given by our school is based upon the foundation laid by parents at home. The Word of God is clear that education begins in the home (Gen. 18:19; Deut. 6:7;

Prov. 22:6; Eph. 6:4; II Tim. 1:5; 3:15). It is our desire to work in cooperation with parents who understand their God-given responsibility to teach their children in the fear and admonition of the Lord.

The families of our students are always welcome to attend the services of Maranatha Baptist Church. Our administration invites parents to contact us at any time to discuss the educational or spiritual needs of their children.



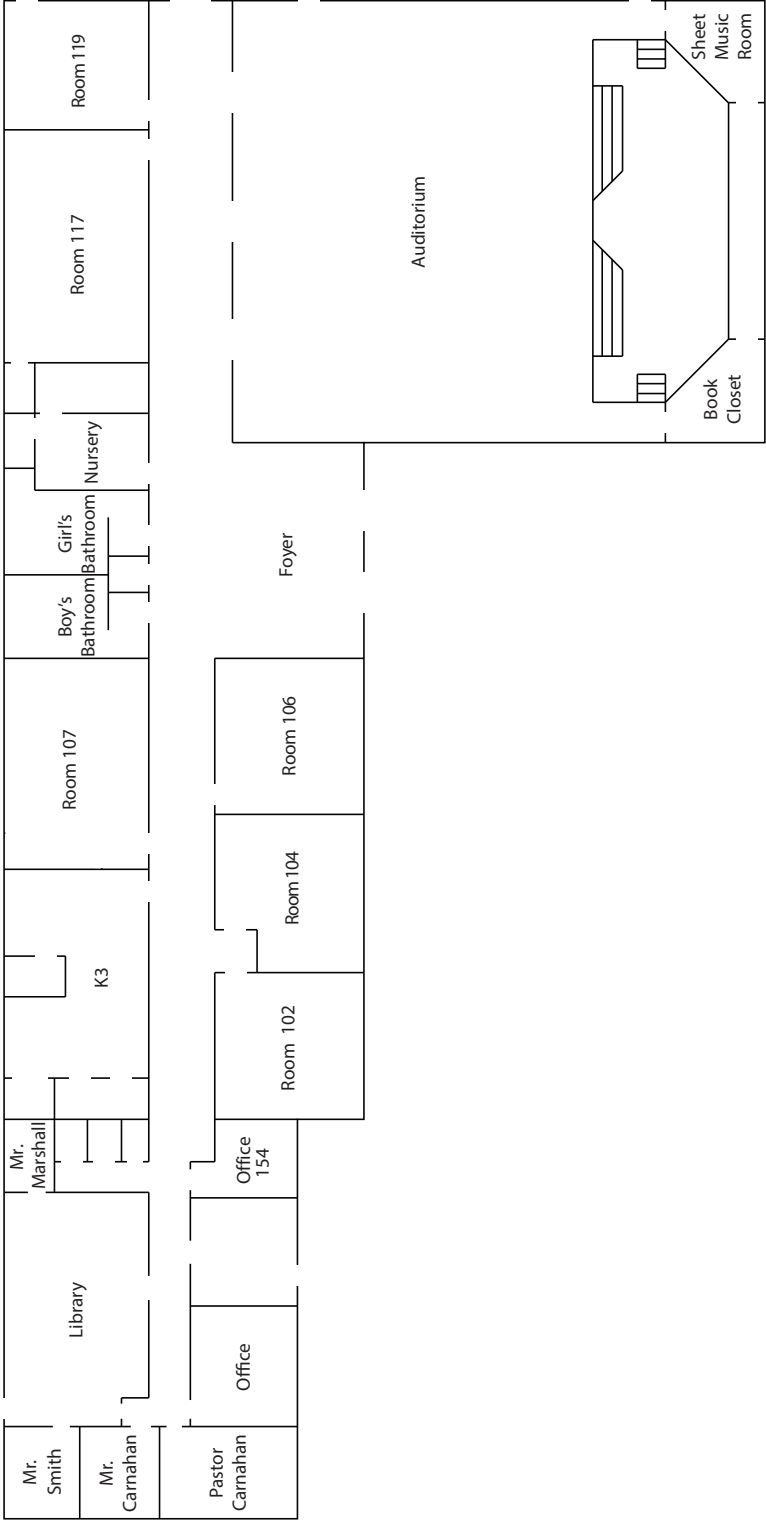

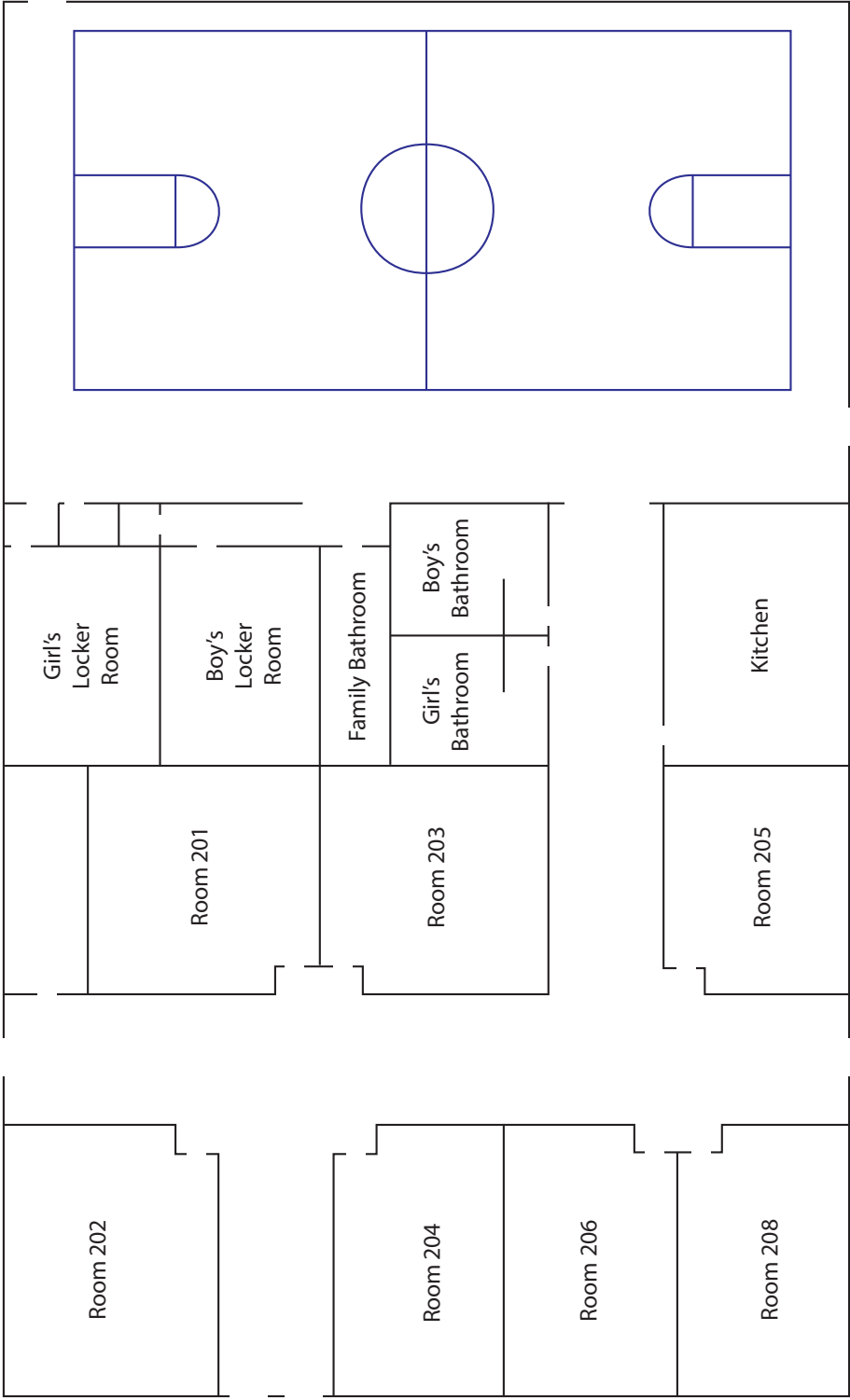

Drop-off/Pick-Up Map

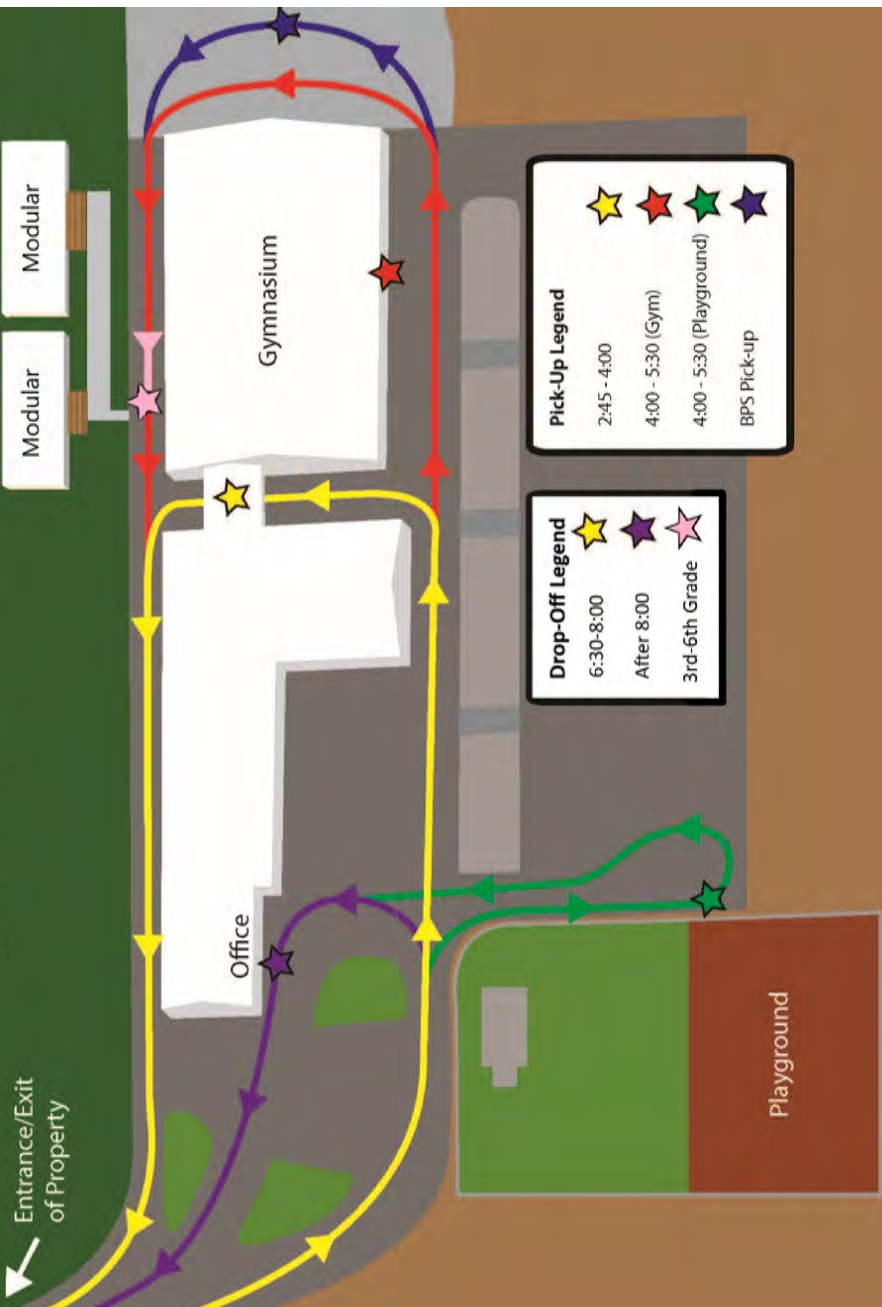

Drop-Off Legend

- 6:30-8:00 (Yellow star)
- After 8:00 (Purple star)
- 3rd-6th Grade (Pink star)

Pick-Up Legend

- 2:45 - 4:00 (Yellow star)
- 4:00 - 5:30 (Gym) (Red star)
- 4:00 - 5:30 (Playground) (Green star)
- BPS Pick-up (Blue star)